

**6 10 Enchufe macho**

Código	ØF	H	H1	H2	D	CH	Conf.
610010	1/4	51	25	13	22,7	15	25
610020	3/8	45	25	5	22,7	17	10
610030	1/2	47	25	7	22,7	21	10

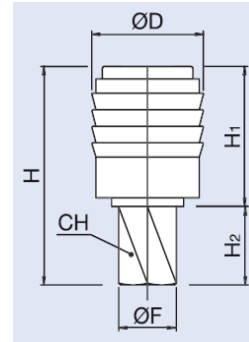
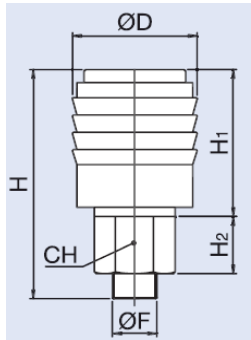

**6 13 Enchufe hembra**

Código	ØF	H	H1	H2	D	CH	Conf.
613010	1/4	48,5	25	19	22,7	17	25
613020	3/8	49,5	25	20	22,7	18	10

**6 15 Enchufe con portagoma**

Código	ØF	H	H1	H2	D	D1	CH	CH1	Conf.
615010	6x14	72,5	25	12	22,7	16,5	15	17	10
615020	8x12	71	25	12	22,7	15	15	15	10
615030	8x17	72	25	12	22,7	18,5	15	19	10
615040	10x19	73	25	12	22,7	21	15	22	10

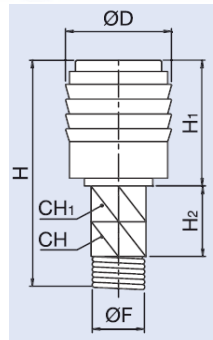
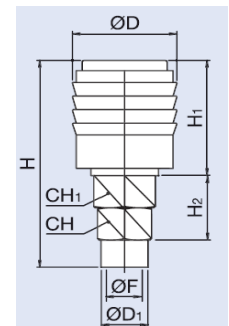

**6 18 Enchufe tubo con muelle**

Código	ØF	H	H1	H2	D	CH	CH1	Conf.
618010	8x6	138	25	23,5	22,7	15	13	10
618020	10x8	138	25	23,5	22,7	15	15	10
618030	12x10	140	25	23,5	22,7	15	17	10

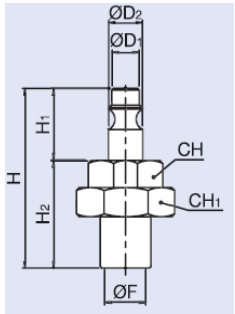

**630 Adaptador con portagoma**

Código	ØF	H	H1	H2	D1	D2	CH	CH1	Conf.
<b>630010</b>	6x14	58,6	23,7	35	7,5	10,5	13	17	10
<b>630020</b>	8x12	58,6	23,7	31,5	7,5	10,5	13	15	10
<b>630030</b>	8x17	58,6	23,7	35	7,5	10,5	13	19	10
<b>630040</b>	10x19	62	25	37	7,5	10,5	14	22	10

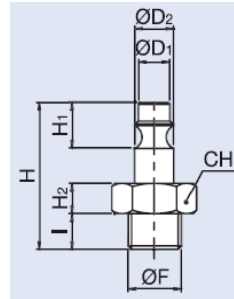

**632 Adaptador macho**

Código	ØF	I	H	H1	H2	D1	D2	CH	Conf.
<b>632000</b>	1/4	8	37	14	5	7,5	12	14	25
<b>632010</b>	3/8	8	37	14	5	7,5	12	17	10

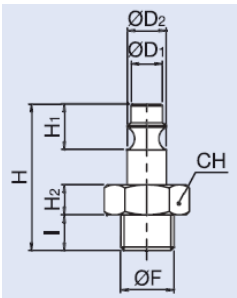

**633 Adaptador macho acero**

Código	ØF	I	H	H1	H2	D1	D2	CH	Conf.
<b>633010</b>	1/4	8	37	14	5	7,5	12	14	25

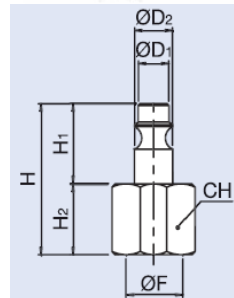

**636 Adaptador hembra**

Código	ØF	H	H1	H2	D1	D2	CH	Conf.
<b>636010</b>	1/4	37	23	14	7,5	12	15	25
<b>636020</b>	3/8	38	24	14	7,5	12	19	10

